

OPERATING MANUAL CONVENIO MANUAL-12



FEATURES



DUAL COMBINATION
ACCESS



HEAVY DUTY
SHOOTING BOLT

Convenio Manual-12
Color - Black

OPERATING INSTRUCTIONS CONVENIO MANUAL SAFE

Ozone Convenio manual safe is designed to help you protect your valuables against theft.

Please install the safe in a cupboard or on a wall/floor and keep the emergency key in a safe place.

Keep the safe in a secret place for paramount security.

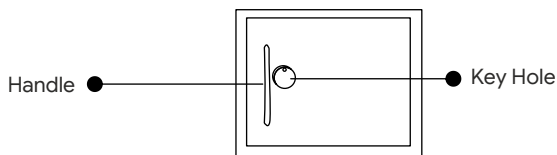

Accessories Include:

- 1) 4 Keys
- 2) 4 Mounting Bolts
- 3) Handle
- 4) Warranty Card

Specifications:

| Model | External Size (HxWxD)mm | Weight (Kg.) | Volume (Ltr.) |
|-----------------------|----------------------------|-----------------|------------------|
| Convenio Manual-12 | 555x350x360 | 24.7 | 55 |

HOW TO OPEN A SAFE FOR THE FIRST TIME

step 1

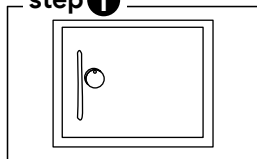

Use both the keys to open the safe

step 2

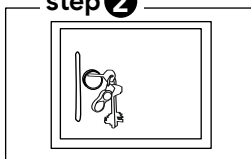

Insert the key no.1 in the key hole & rotate it clockwise and remove it

step 3

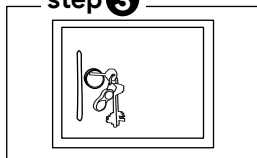

Insert the key no.2 in the key hole & rotate it clockwise and remove it

step 4

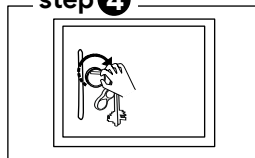

Now the safe is opened

HOW TO CLOSE A SAFE FOR THE FIRST TIME

step 1

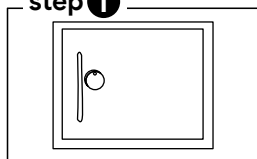

Use both the keys to open the safe

step 2

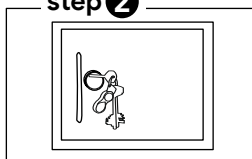

Insert the key no.2 in the key hole & rotate it Anti-clockwise and remove it

step 3

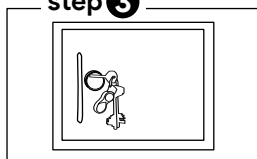

Insert the key no.1 in the key hole & rotate it Anti-clockwise and remove it

step 4



Now the safe is closed

1. Shooting Bolts
2. Hidden Hinges
3. Handle Hub
4. Key Hole

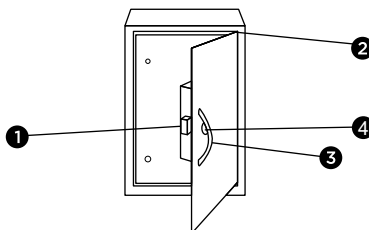

INSTALLING THE SAFE

Safe can be easily install in wardrobe or on wall.

Fix the safe in the place which is not easy to move.

Drill holes for expansion bolts (or clamping screws)in the right place.

Turn the expansion bolts counter clockwise to separate.

Use the expansion bolts (or clamping screws) to secure the case to the wall.

Make sure the case is mounted in place as required and then tighten all screws.

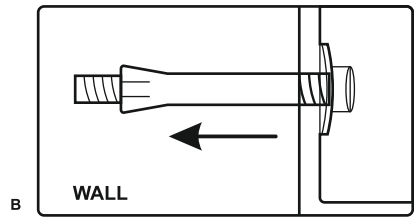
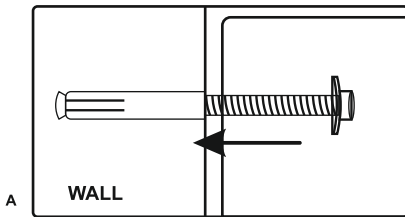
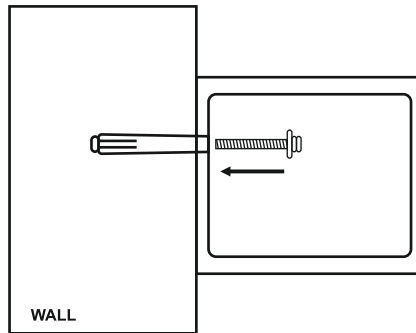

| Do's | Don'ts |
|--|---|
| 1) On receipt of the safe, install it properly | 1) Don't leave the safe in open position |
| 2) Keep mechanical override key (Emergency Key) at a Safer place | 2) Do not install safe in Moisture areas |
| 3) Please check the door properly after closing the door | 3) Do not apply any extra force on the keys on opening and closing the door |

OZONE DIGITAL SAFE- CHECK LIST

MODEL NO.: _____ **SERIAL NO.:** _____

DATE: _____ **DATE OF DELIVERY:** _____

CONTENTS:-

- | | |
|--------------------------|--------------------------|
| 1. EMERGENCY KEY | <input type="checkbox"/> |
| 2. PANEL KEY | <input type="checkbox"/> |
| 3. DRAWER KEY | <input type="checkbox"/> |
| 4. BATTERIES | <input type="checkbox"/> |
| 5. ADAPTOR | <input type="checkbox"/> |
| 6. RFID CARD | <input type="checkbox"/> |
| 7. FASTNER | <input type="checkbox"/> |
| 8. MANUAL | <input type="checkbox"/> |
| 9. OPERATION CHECK | <input type="checkbox"/> |
| 10. BODY DAMAGE (IF ANY) | <input type="checkbox"/> |

INSPECTED BY :- _____

CUSTOMER / DEALER SIGNATURE & SEAL

E-Mail : Info@ozonesecutech.com | Website: www.ozonesecutech.com
Customer Care: 9310012300